

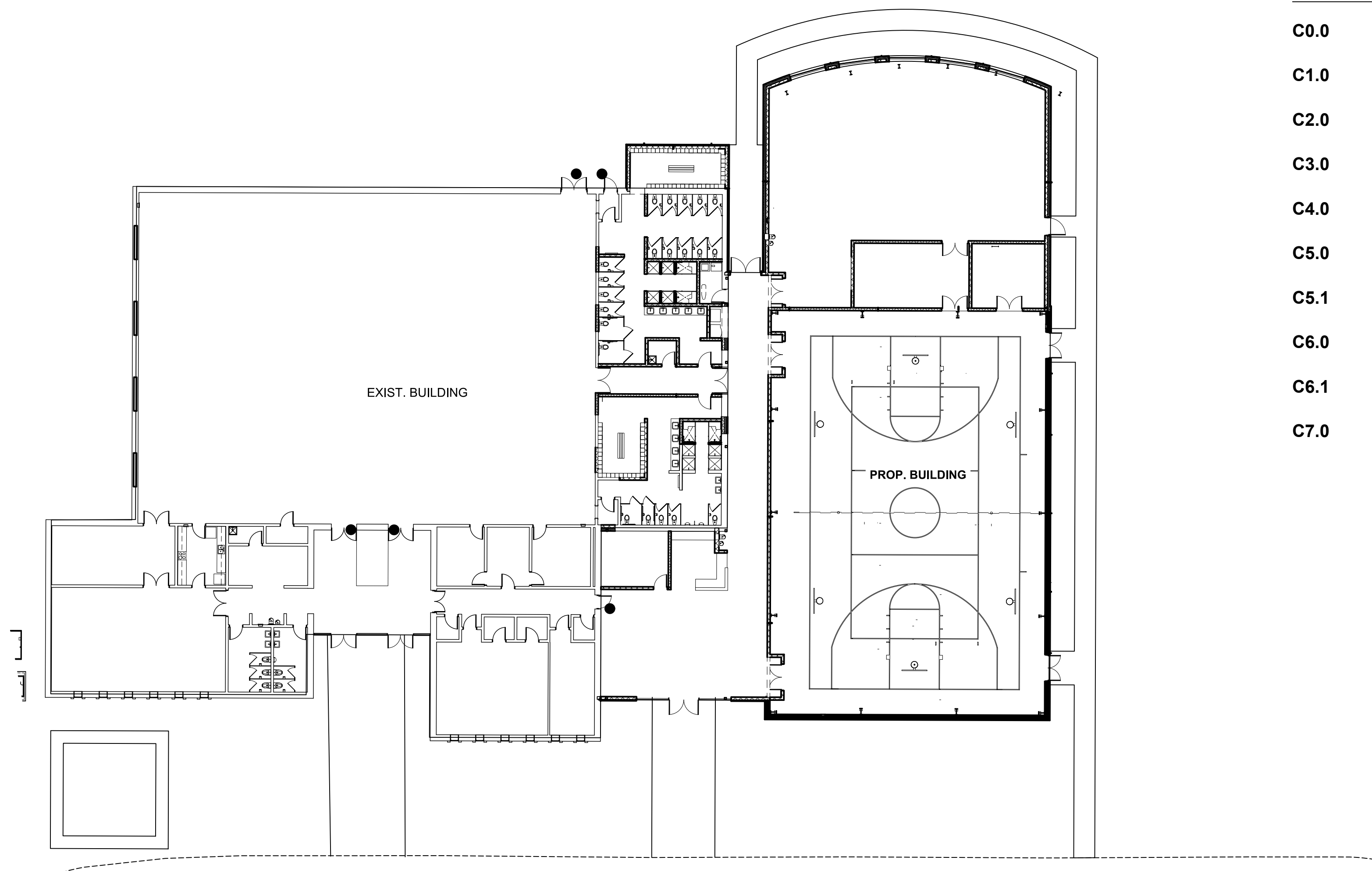

# SITWORK PLANS FOR: COLLETON RECREATION CENTER EXPANSION

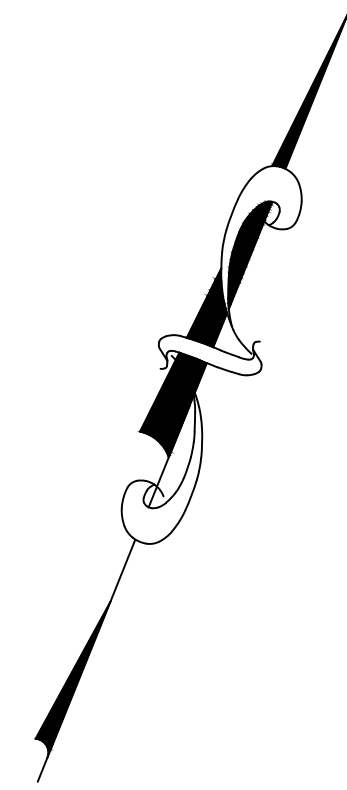
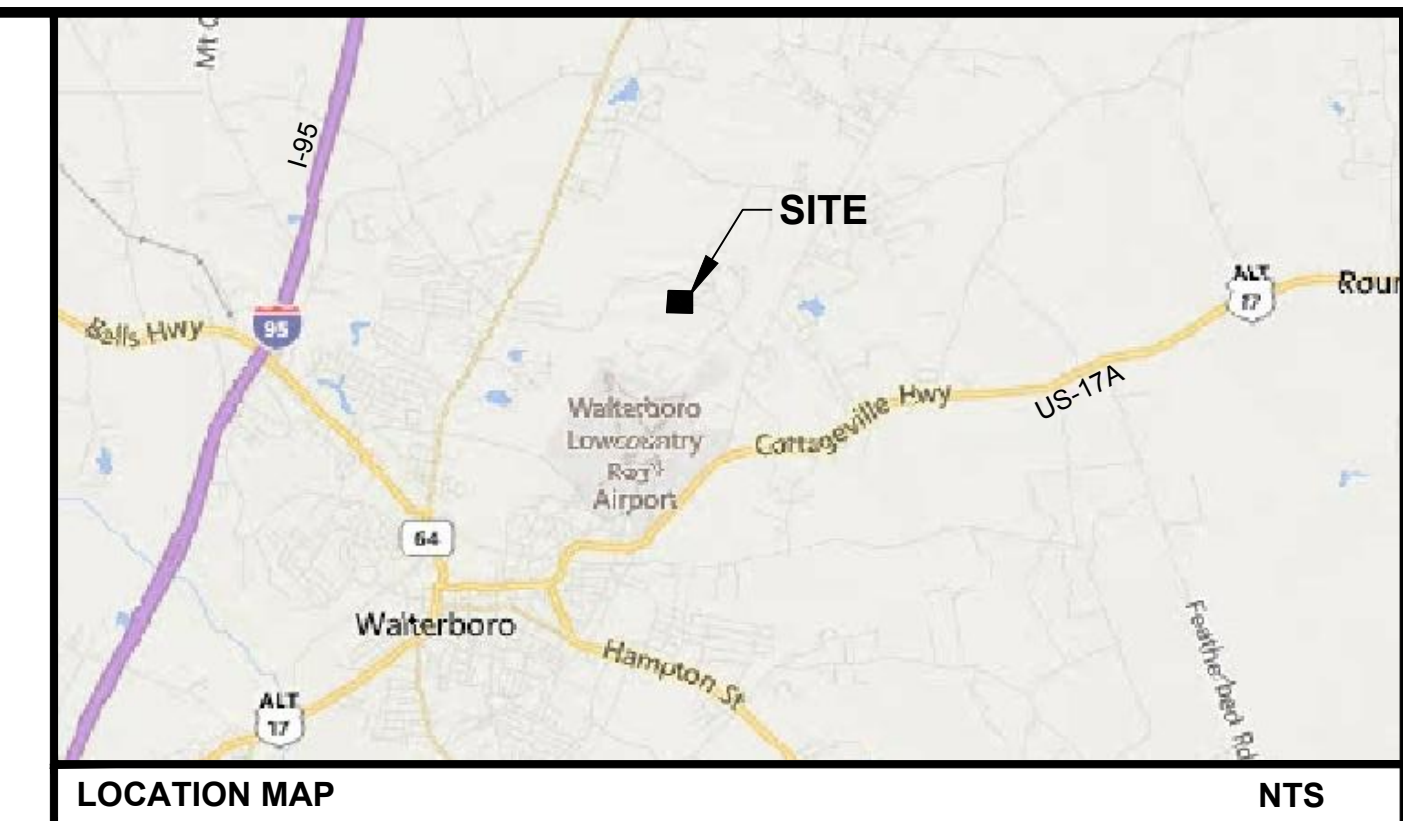

**INDEX OF SHEETS**

SHEET NO.	SHEET NAME	ORIGINAL DATE
C0.0	COVER SHEET	5/30/2017
C1.0	TOPOGRAPHIC SURVEY	03/10/16
C2.0	EXISTING CONDITIONS & DEMOLITION PLAN	5/30/2017
C3.0	SITE PLAN	5/30/2017
C4.0	GRADING & DRAINAGE PLAN	5/30/2017
C5.0	EROSION CONTROL PLAN	5/30/2017
C5.1	EROSION CONTROL DETAILS	5/30/2017
C6.0	UTILITY PLAN	5/30/2017
C6.1	UTILITY DETAILS	5/30/2017
C7.0	DEVELOPMENT DETAILS	5/30/2017

**ENGINEERING FIRM:** INFRASTRUCTURE CONSULTING & ENGINEERING, PLLC.  
**ADDRESS:** 26 JOHN GALT ROAD, STE. A, BEAUFORT, SC 29906  
**PHONE:** 843-522-0246  
**CONTACT:** JARED FRALIX, PE

**ARCHITECT:** CLARK PATTERSON LEE  
**ADDRESS:** 6302 FAIRVIEW ROAD, STE. 102, CHARLOTTE, NC 28210  
**PHONE:** 800-274-9000  
**CONTACT:** RACHEL GUILLOT

**OWNER:** COLLETON COUNTY  
**ADDRESS:** 113 MABLE T. WILLIS BLVD., WALTERBORO, SC 29488  
**PHONE:** 843-539-1967  
**CONTACT:** JOHN T. STIEGLITZ, III

**WATER/SEWER:** CITY OF WALTERBORO  
**ADDRESS:** 248 HAMPTON STREET, WALTERBORO, SC 29488  
**PHONE:** 843-782-1020  
**CONTACT:** WAYNE CROSBY

**ELECTRIC/GAS:** SCE&G  
**ADDRESS:** P.O. BOX 100255, COLUMBIA, SC 29202  
**PHONE:** (843)549-8600  
**CONTACT:** TODD LITCHFIELD

REV. NO.	BY	DATE	DESCRIPTION OF REVISION

PROJECT INFORMATION	
DESIGNED BY:	AW
DRAWN BY:	AW
CHECKED BY:	JF
PROJECT NUMBER:	16-32
ORIGINAL DATE:	05/30/17

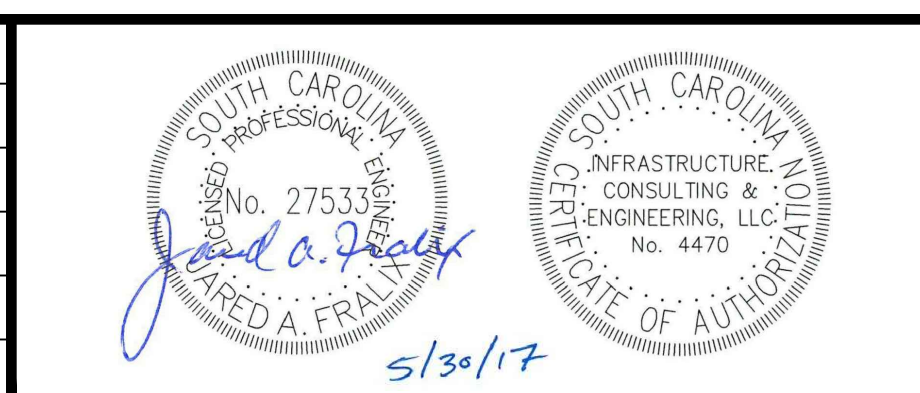

**IE INFRASTRUCTURE CONSULTING & ENGINEERING**  
 26 JOHN GALT ROAD, STE. A, BEAUFORT, SC 29906 | 843-522-0246 | WWW.ICE-ENG.COM  
 COLUMBIA | NORTH CHARLESTON | RALEIGH | ATLANTA | AUSTIN | TAMPA | OTHER MAJOR CITIES

<b>COLLETON RECREATION CENTER EXPANSION</b>	
COLLETON COUNTY	WALTERBORO, SC
COVER SHEET	<b>C0.0</b>

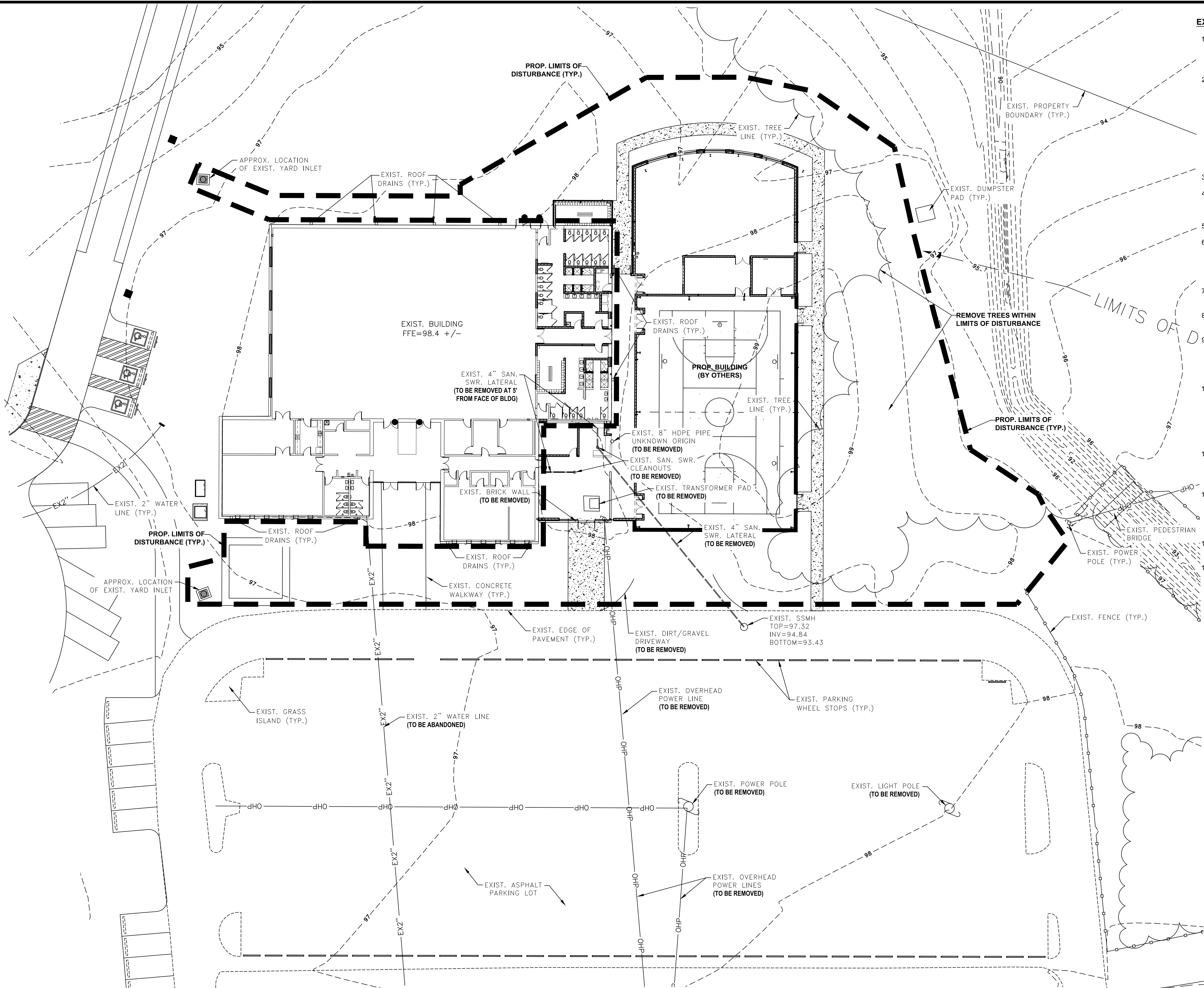

**EXISTING CONDITIONS AND DEMOLITION NOTES:**

- EXISTING TOPOGRAPHICAL DATA OBTAINED FROM "A TOPOGRAPHICAL SURVEY A PORTION OF TMS 148-00-00-137 SURVEYED FOR COLLETON COUNTY" BY FOWLER LAND SURVEYING, LLC DATED MARCH 10, 2016 AND UPDATED AUGUST 19, 2016.
- BENCHMARK #1:  
40p NAIL IN PP  
ELEVATION = 93.39  
NAVD'88 DATUM  
(OUTSIDE OF SHEET LIMITS)
- BENCHMARK #2:  
40p NAIL IN LAMP POLE  
ELEVATION = 100.48  
NAVD'88 DATUM  
(OUTSIDE OF SHEET LIMITS)
- LIMITS OF DISTURBANCE = 0.90 ACRES
- CONTRACTOR SHALL VERIFY EXISTING GRADES PRIOR TO CONSTRUCTION COMMENCING. CONTRACTOR SHALL NOTIFY ENGINEER OF ANY PLAN VARIATION.
- THE PURPOSE OF THIS PLAN IS FOR DEMOLITION ONLY.
- CONTRACTOR SHALL BE RESPONSIBLE FOR CONTACTING ALL APPROPRIATE UTILITIES AND ENSURING THAT UTILITIES ARE LOCATED PRIOR TO CONSTRUCTION BEGINNING ACCORDING TO SC STATE LAW. CONTRACTOR SHALL CONFIRM LOCATION AND DEPTHS OF ALL EXISTING UTILITIES PRIOR TO CONSTRUCTION.
- CONTRACTOR SHALL BE ENTIRELY RESPONSIBLE FOR REPAIR AND/OR REPLACEMENT OF ANY UTILITIES DAMAGED DURING CONSTRUCTION.
- CONTRACTOR SHALL COORDINATE THE REMOVAL AND/OR RELOCATION OF ANY EXISTING UTILITIES WITH THE APPROPRIATE UTILITY COMPANY.
- ALL NECESSARY PERMITS FOR DEMOLITION SHALL BE OBTAINED BY THE CONTRACTOR PRIOR TO BEGINNING WORK. CONTRACTOR SHALL PROTECT ALL ADJACENT LANDS FROM DAMAGE DURING DEMOLITION WORK. ANY OFF SITE AREAS DISTURBED SHALL BE RETURNED TO A CONDITION EQUAL TO OR BETTER THAN THE EXISTING CONDITION.
- CLEARING AND GRUBBING SHALL BE PERFORMED WITHIN THE LIMITS SHOWN ON THE PLANS. ALL TIMBER, BRUSH ROOTS, STUMPS, TREES, OR OTHER VEGETATION CUT DURING THE CLEARING OPERATION SHALL BECOME THE CONTRACTOR'S RESPONSIBILITY TO DISPOSE OF PROPERLY, AND SHALL BE EITHER REMOVED FROM THE PROJECT SITE BY THE CONTRACTOR, OR SATISFACTORILY DISPOSED OF ON-SITE WITH APPROVAL FROM THE OWNER.
- DEMOLITION MATERIAL SHALL BE LEGALLY DISPOSED OF OFF SITE. ALL DEBRIS SHALL BE HAULED OFF SITE TO A DISPOSAL AREA APPROVED BY THE STATE OF SOUTH CAROLINA FOR THE HANDLING OF DEMOLITION DEBRIS.
- ALL STRUCTURES NOT LABELED FOR DEMOLITION SHALL BE PROTECTED FROM DAMAGE DURING CONSTRUCTION. ANY STRUCTURES THAT ARE TO REMAIN THAT ARE DAMAGED SHALL BE REPAIRED BY THE CONTRACTOR AT NO ADDITIONAL COST. THE OWNER AND ENGINEER SHALL BE IMMEDIATELY NOTIFIED OF DAMAGE TO ANY EXISTING STRUCTURE.
- THE CONTRACTOR SHALL PROTECT TREES AND SHRUBS OUTSIDE OF THE CUT/FILL LINES.
- CONSTRUCTION ENTRANCE AND SILT FENCE PER THE APPROVED EROSION CONTROL PLANS SHALL BE IN PLACE PRIOR TO DEMOLITION OPERATIONS.

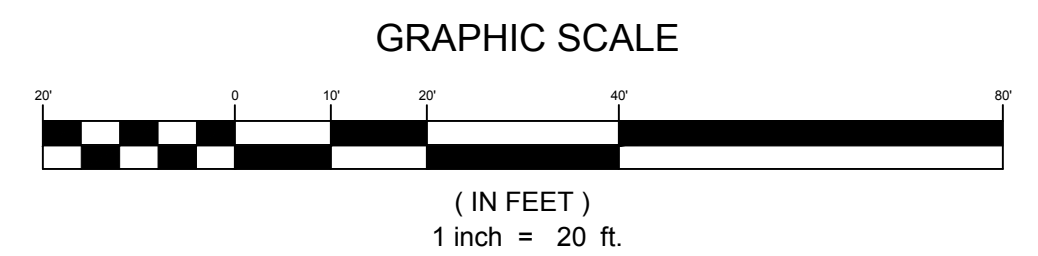
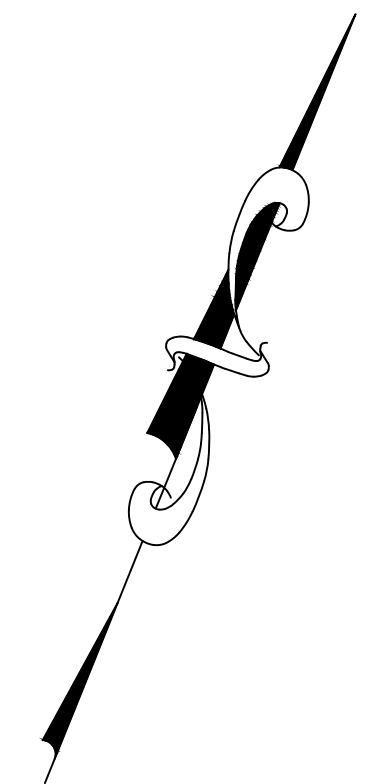

REV. NO.	BY	DATE	DESCRIPTION OF REVISION

PROJECT INFORMATION	
DESIGNED BY:	AW
DRAWN BY:	AW
CHECKED BY:	JF
PROJECT NUMBER:	16-32
ORIGINAL DATE:	05/30/17

**IE INFRASTRUCTURE CONSULTING & ENGINEERING**  
 26 JOHN GALT ROAD, STE. A, BEAUFORT, SC 29906 | 843-522-0246 | WWW.IE-ENG.COM  
 COLUMBIA | NORTH CHARLESTON | RALEIGH | ATLANTA | AUSTIN | TAMPA | OTHER MAJOR CITIES

**COLLETON RECREATION CENTER EXPANSION**  
 COLLETON COUNTY WALTERBORO, SC

**EXISTING CONDITIONS & DEMOLITION PLAN**

**C2.0**

N/F  
 COLLETON COUNTY  
 TMS 148-00-00-035  
 PB 17 PAGE 142

**SITE SUMMARY:**

TAX PARCEL NO: TMS 148-00-00-035.000  
 PARCEL AREA: 7.5 ACRES  
 EXISTING ZONING: INDUSTRIAL DISTRICT (ID)  
 PARCEL ADDRESS: 280 RECREATION LANE  
 WALTERBORO, SC 29488  
 DEVELOPER/OWNER: COLLETON COUNTY  
 113 MAPLE T. WILLIS BLVD.  
 WALTERBORO, SC 29488

**SITE NOTES:**

1. ALL SITE CONCRETE (SIDEWALKS, CURB & GUTTER, ETC.) SHALL NOT BE LESS THAN 3,000 PSI STRENGTH AT 28 DAYS, UNLESS NOTED OTHERWISE.
2. SEE ARCHITECTURAL PLANS BY OTHERS FOR BUILDING CONSTRUCTION DETAILS.
3. LANDSCAPING, IRRIGATION, AND LIGHTING PLANS TO BE PROVIDED BY OTHERS.

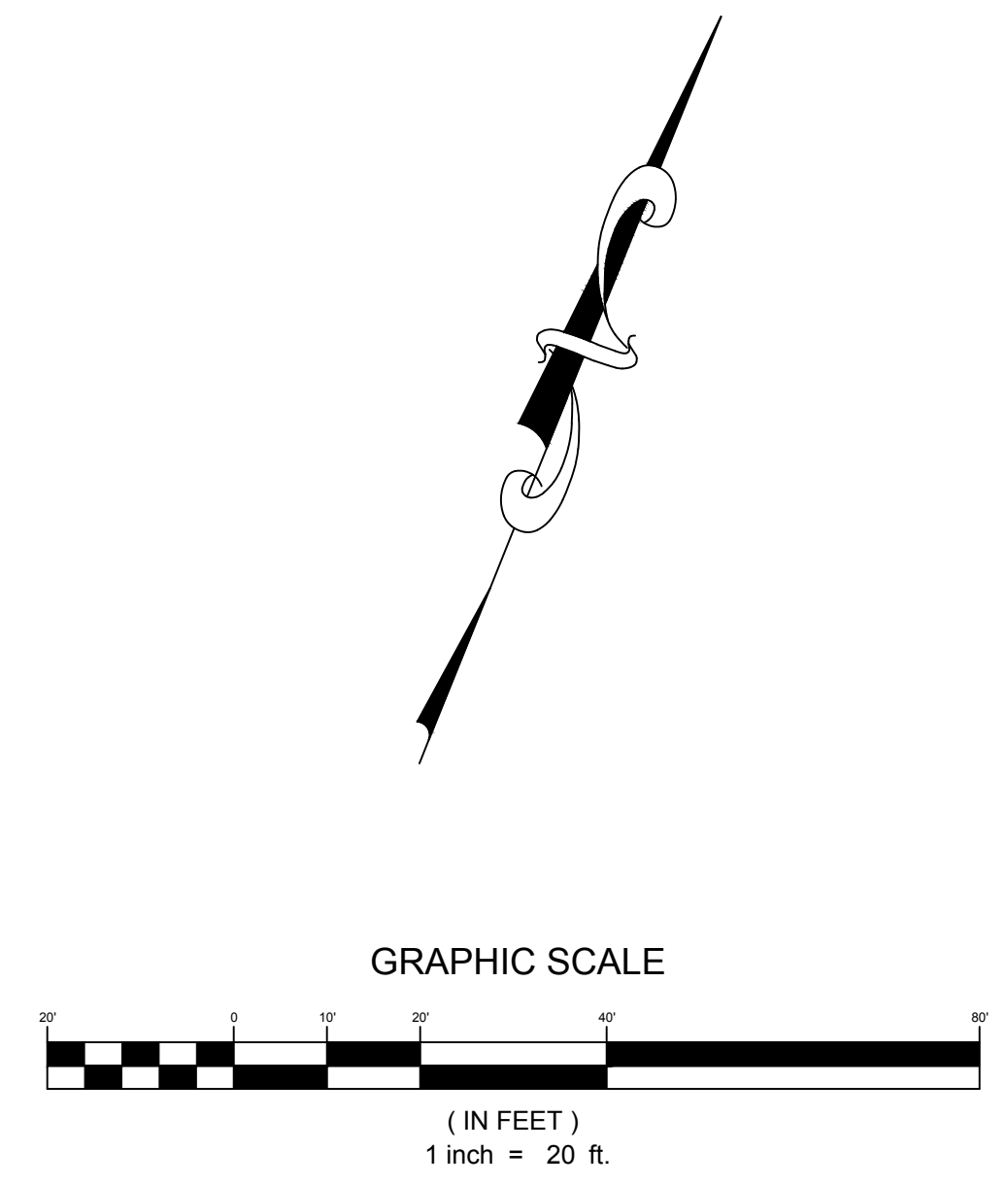
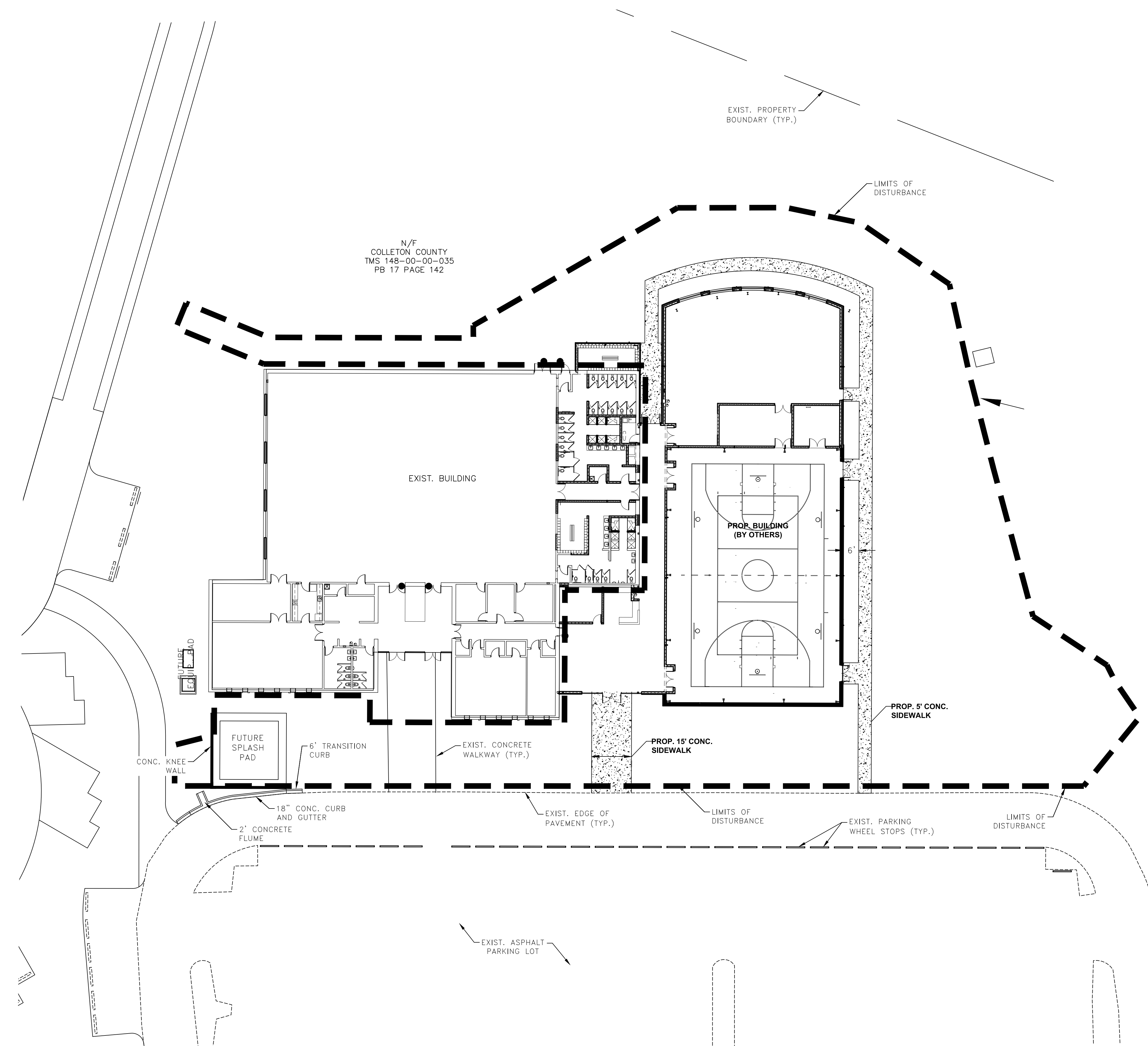

REV. NO.	BY	DATE	DESCRIPTION OF REVISION

PROJECT INFORMATION	
DESIGNED BY:	AW
DRAWN BY:	AW
CHECKED BY:	JF
PROJECT NUMBER:	16-32
ORIGINAL DATE:	05/30/17

**IE INFRASTRUCTURE CONSULTING & ENGINEERING**  
 26 JOHN GALT ROAD, STE. A, BEAUFORT, SC 29906 | 843-522-0246 | WWW.IE-ENG.COM  
 COLUMBIA | NORTH CHARLESTON | RALEIGH | ATLANTA | AUSTIN | TAMPA | OTHER MAJOR CITIES

**COLLETON RECREATION CENTER EXPANSION**  
 COLLETON COUNTY WALTERBORO, SC

SITE PLAN **C3.0**

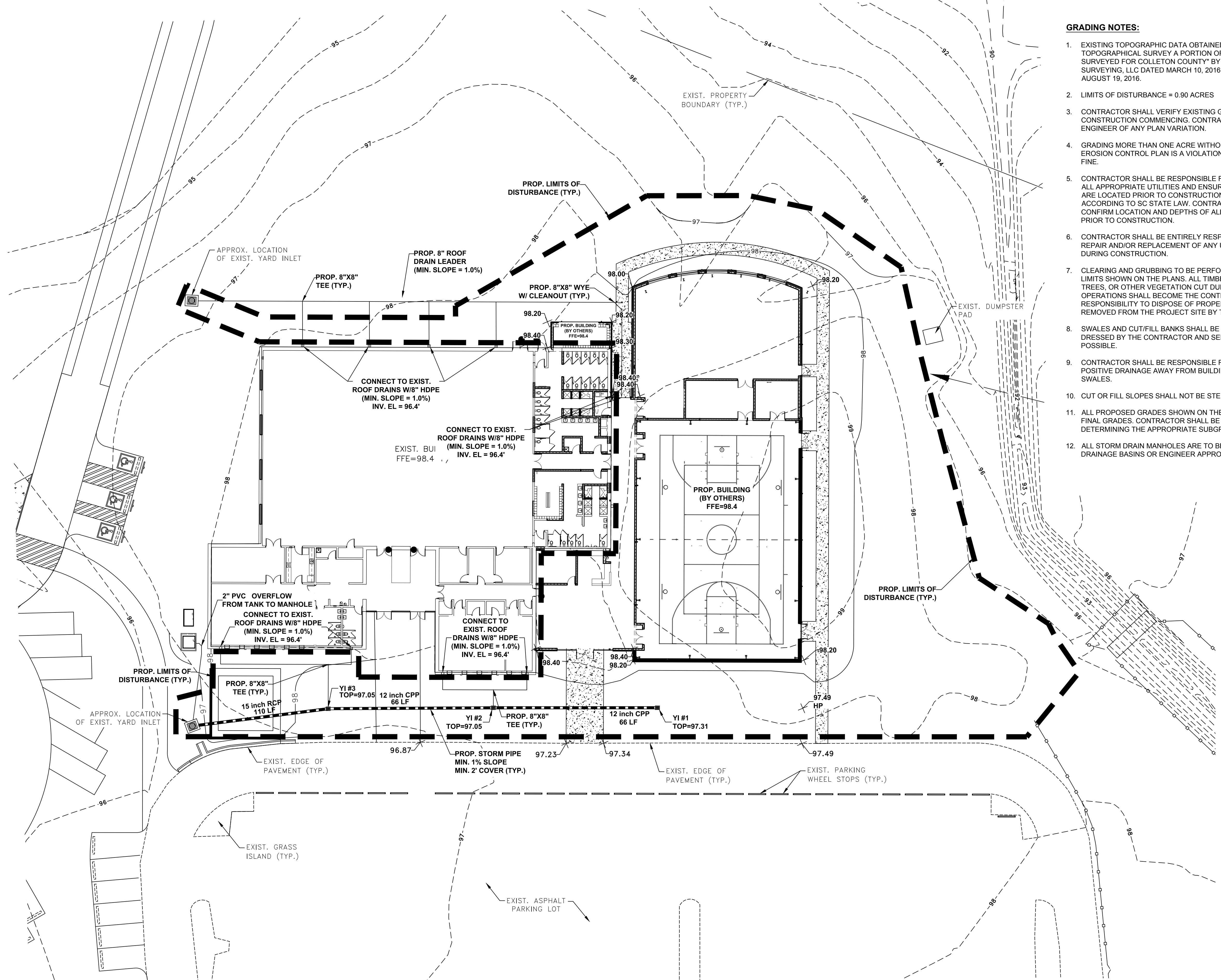

- GRADING NOTES:**
- EXISTING TOPOGRAPHICAL DATA OBTAINED FROM "A TOPOGRAPHICAL SURVEY A PORTION OF TMS 148-00-00-137 SURVEYED FOR COLLETON COUNTY" BY FOWLER LAND SURVEYING, LLC DATED MARCH 10, 2016 AND UPDATED AUGUST 19, 2016.
  - LIMITS OF DISTURBANCE = 0.90 ACRES
  - CONTRACTOR SHALL VERIFY EXISTING GRADES PRIOR TO CONSTRUCTION COMMENCING. CONTRACTOR SHALL NOTIFY ENGINEER OF ANY PLAN VARIATION.
  - GRADING MORE THAN ONE ACRE WITHOUT AN APPROVED EROSION CONTROL PLAN IS A VIOLATION AND SUBJECT TO A FINE.
  - CONTRACTOR SHALL BE RESPONSIBLE FOR CONTACTING ALL APPROPRIATE UTILITIES AND ENSURING THAT UTILITIES ARE LOCATED PRIOR TO CONSTRUCTION BEGINNING ACCORDING TO SC STATE LAW. CONTRACTOR SHALL CONFIRM LOCATION AND DEPTHS OF ALL EXISTING UTILITIES PRIOR TO CONSTRUCTION.
  - CONTRACTOR SHALL BE ENTIRELY RESPONSIBLE FOR REPAIR AND/OR REPLACEMENT OF ANY UTILITIES DAMAGED DURING CONSTRUCTION.
  - CLEARING AND GRUBBING TO BE PERFORMED WITHIN THE LIMITS SHOWN ON THE PLANS. ALL TIMBER, BRUSH, STUMPS, TREES, OR OTHER VEGETATION CUT DURING THE CLEARING OPERATIONS SHALL BECOME THE CONTRACTOR'S RESPONSIBILITY TO DISPOSE OF PROPERLY, AND SHALL BE REMOVED FROM THE PROJECT SITE BY THE CONTRACTOR.
  - SWALES AND CUT/FILL BANKS SHALL BE COMPLETELY DRESSED BY THE CONTRACTOR AND SEEDED AS SOON AS POSSIBLE.
  - CONTRACTOR SHALL BE RESPONSIBLE FOR ENSURING POSITIVE DRAINAGE AWAY FROM BUILDING AND ALONG ALL SWALES.
  - CUT OR FILL SLOPES SHALL NOT BE STEEPER THAN 2.0H:1.0V
  - ALL PROPOSED GRADES SHOWN ON THESE PLANS ARE FINAL GRADES. CONTRACTOR SHALL BE RESPONSIBLE FOR DETERMINING THE APPROPRIATE SUBGRADE ELEVATIONS.
  - ALL STORM DRAIN MANHOLES ARE TO BE NYLOPLAST DRAINAGE BASINS OR ENGINEER APPROVED EQUIVALENT.

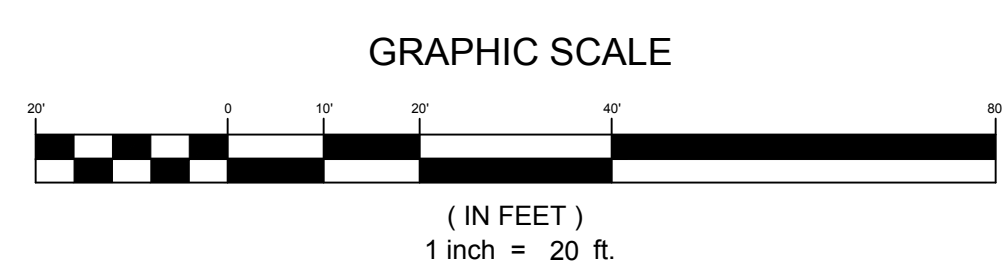

REV. NO.	BY	DATE	DESCRIPTION OF REVISION

PROJECT INFORMATION	
DESIGNED BY:	AW
DRAWN BY:	AW
CHECKED BY:	JF
PROJECT NUMBER:	16-32
ORIGINAL DATE:	05/30/17

**IE INFRASTRUCTURE CONSULTING & ENGINEERING**

26 JOHN GALT ROAD, STE. A, BEAUFORT, SC 29906 | 843-522-0246 | WWW.IE-ENG.COM  
 COLUMBIA | NORTH CHARLESTON | RALEIGH | ATLANTA | AUSTIN | TAMPA | OTHER MAJOR CITIES

**COLLETON RECREATION CENTER EXPANSION**  
 COLLETON COUNTY WALTERBORO, SC

**GRADING & DRAINAGE PLAN**

**C4.0**